

## KEYSTONE STANDARD UNITS

### *Applications*

- Commercial
- Residential
- Fill walls or cut walls



### *Site Management Advantage*

- Enables unit stacking and backfilling operation to occur simultaneously
- Stack from the front or back of wall
- Reach difficult areas with safety and ease



**KEYSET**

Telephone 800.747.8971

**KEYSET**

Keystone Retaining Wall Systems, Inc. • A CONTECH Company  
4444 West 78<sup>th</sup> Street, Minneapolis, Minnesota 55435

**KEYSET**

POWERFUL • EFFICIENT • PRECISE



# INSTALLATION EQUIPMENT

*for*

**KEYSTONE STANDARD UNITS**



1

Keysset locks into the center of the 3 Standard units facing the same direction.



2

Keysset brings the units into alignment and sets them on the wall.



3

## APPLICATION

Are you still lifting one Standard unit at a time? Keysset is the ultimate piece of equipment that enables you to grab, lift and set 3 Keystone Standard units at a time. No need to rearrange the units because you are picking from the pallet the way they are already configured, bringing them into alignment and setting them at the wall. Even the pins can be installed at the pallet!

## OPERATION

Keysset suspends from the arm of any size track hoe or boom skid steer attachment. It uses the hydraulics on your equipment to give you the power and versatility that manual devices don't have. Simply connect the two hoses to your existing auxiliary hydraulics and Keysset is ready for operation.

## ADVANTAGES

Keysset affords you the opportunity to install the best retaining wall unit available, faster and with less effort. By performing the stacking and dirt moving operations simultaneously, your productivity is greatly improved. Regardless of site accessibility, you will find that Keysset assists in material handling, making your crew more efficient, profitable and eager to conquer the next day. Make Keysset a part of your expert team and increase your edge over the competition.



## SPECIFICATIONS

Weight: 250 lbs. (empty)

Lifts: 3 Standard Units

Hydraulic Operating Pressure: 1500 to 3000 psi

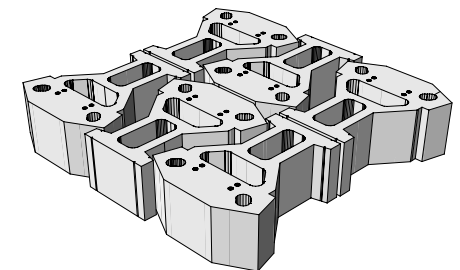

Standard Pallet Configuration

*3 units are moved effortlessly in place with operator guidance.*